

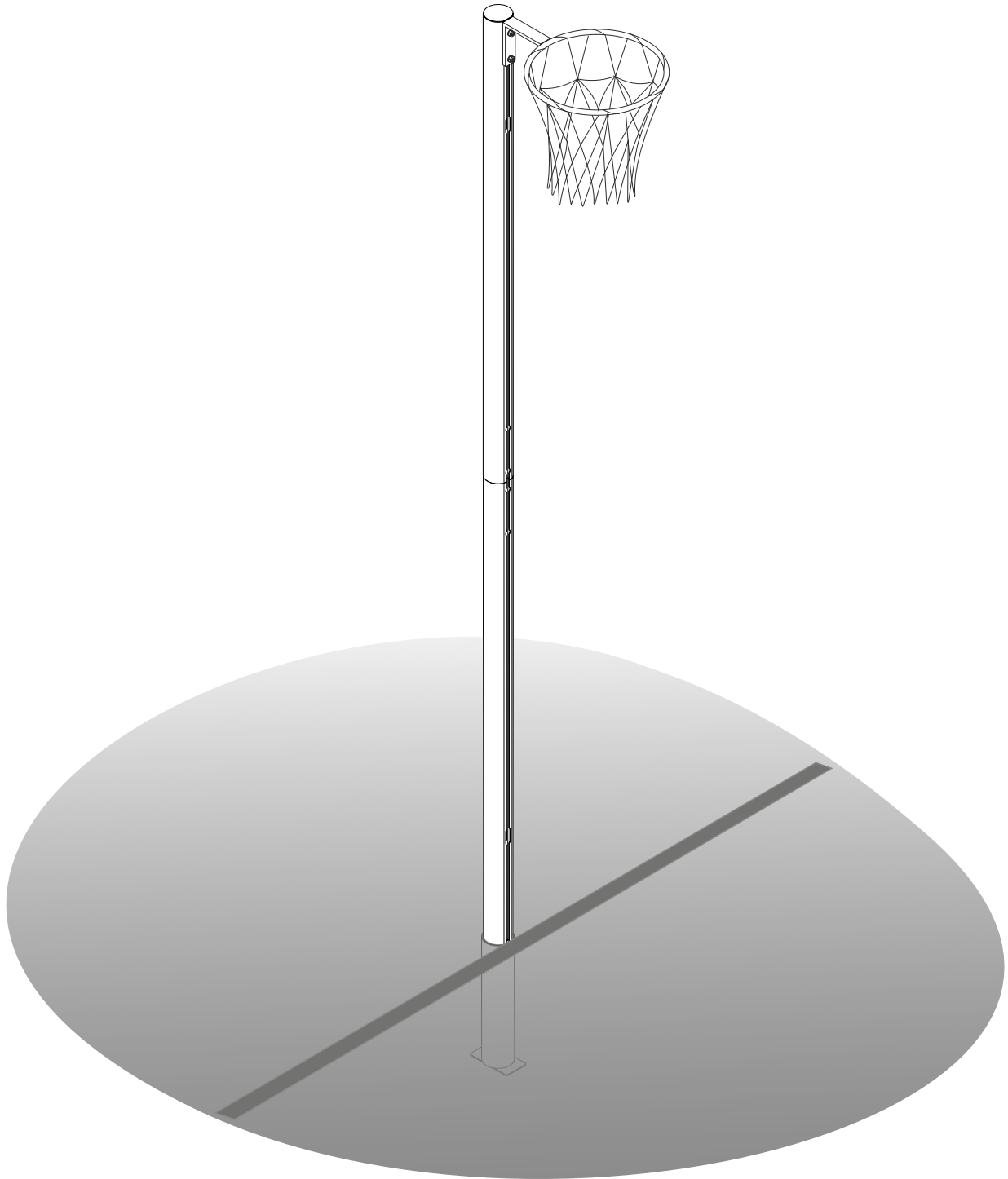

FORZA

SOCKETED NETBALL POST



NET WORLD SPORTS»

    @NetWorldSports

www.networldsports.co.uk // +44 (0) 1691 683 807 // cs@networldsports.co.uk

www.networldsports.com // 1-866-861-9095 // cs@networldsports.com

PARTS LIST

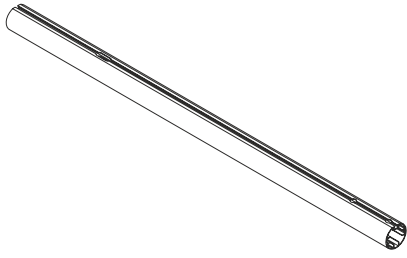

PA45297
Socketed Post (x2)

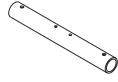

PA45230
Rail connector (x1)

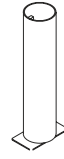

PA45298
Ground socket (x1)

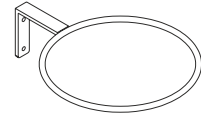

PA45292
Hoop (x1)



PA45288
Rubber end cap (x1)



PA45235
Ground socket cap (x1)



PA45273
M8x16 hex head bolt (x4)



PA38101
M10x20 bolt (x2)

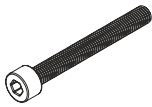

PA45172
M10x80 hex head bolt (x2)



PA38115
M10 lock nut (x6)



PA38122
M10 Washer (X10)



PA38133
M8 Spring washer (x4)

HANDY EXTRAS

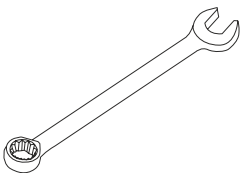

Wrench

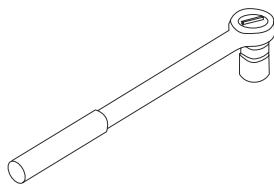

Ratchet

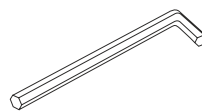

Allen Key

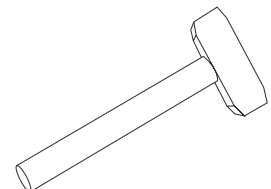

Rubber mallet

IMPORTANT

1. Read through the instructions thoroughly before assembling.
2. Installation, movement and use of equipment should be carried out under the supervision of a competent person using due diligence and risk assessment.
3. Take extreme care when installing, moving and lifting components.
4. Check all parts are present with no defects prior to the assembly.
5. Safety/warning stickers on the product must be visible at all times.
6. Never climb or swing on the product
7. We recommend lubricating/greasing the appropriate components (winders, sockets, inserts, nuts and bolts) to prolong lifespan.
8. Regularly inspect and maintain the equipment to ensure it is safe to use working correctly and to increase lifespan.

2 people will be required to fit post to base

Step 1. Assemble post.

layout out the 2 post sections (PA45293) and the rail connector (PA45230). Slide the rail connector into one end of a post with 2 pre-drilled holes. Align both sets of pre-drilled holes and secure in place with 1 M10x80(PA45172) hex bolt and M10 lock nut (PA38115) using M10 washers (PA38122) in between and 1 M8x16 hex bolt (PA45273) and spring washer (PA38133). See Fig.1.

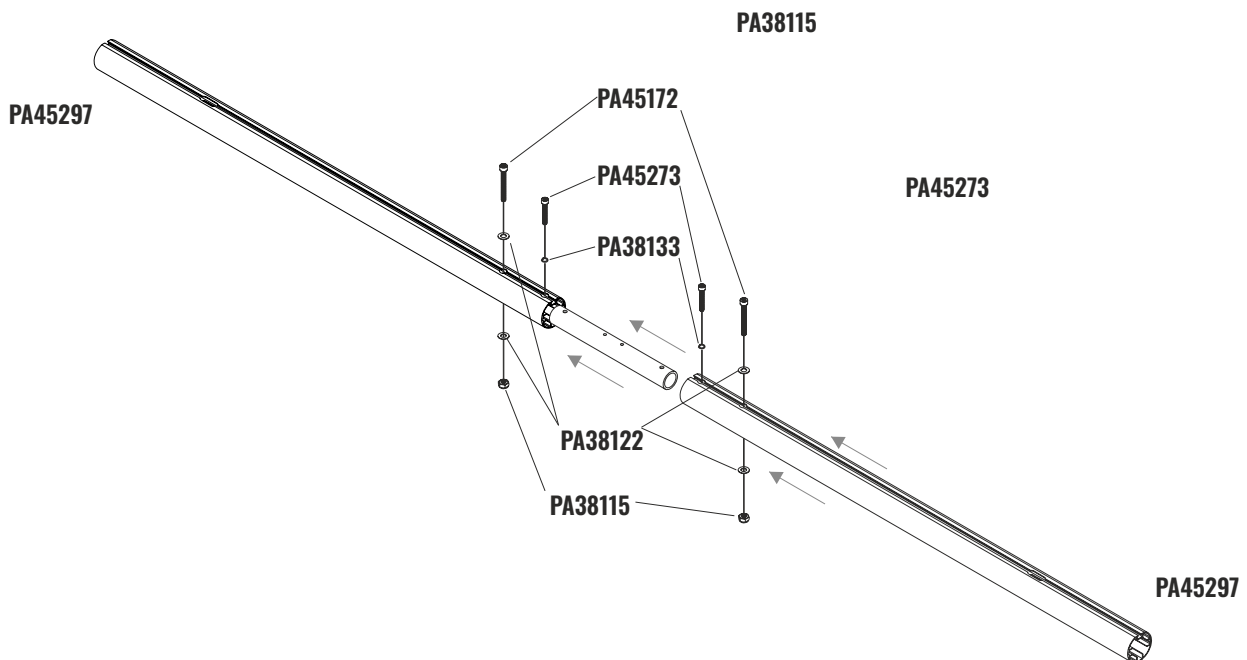

Slide the 2nd post on to the rail connector and secure using same method as above.

Step 2. Fit hoop and End cap.

Slide 2 M10x20 (PA38101) bolts into the channel at 1 end of the assembled post, locate the hoop (PA45292) over the bolts and choose the required position. Once the Hoop is in position secure in place with M10 washers and M10 lock nut. Once hoop is attached tap rubber (PA45288) end cap into place with a rubber mallet. See Fig.2. and Fig.2a

Please note that the net should be attached the hoop at this point.

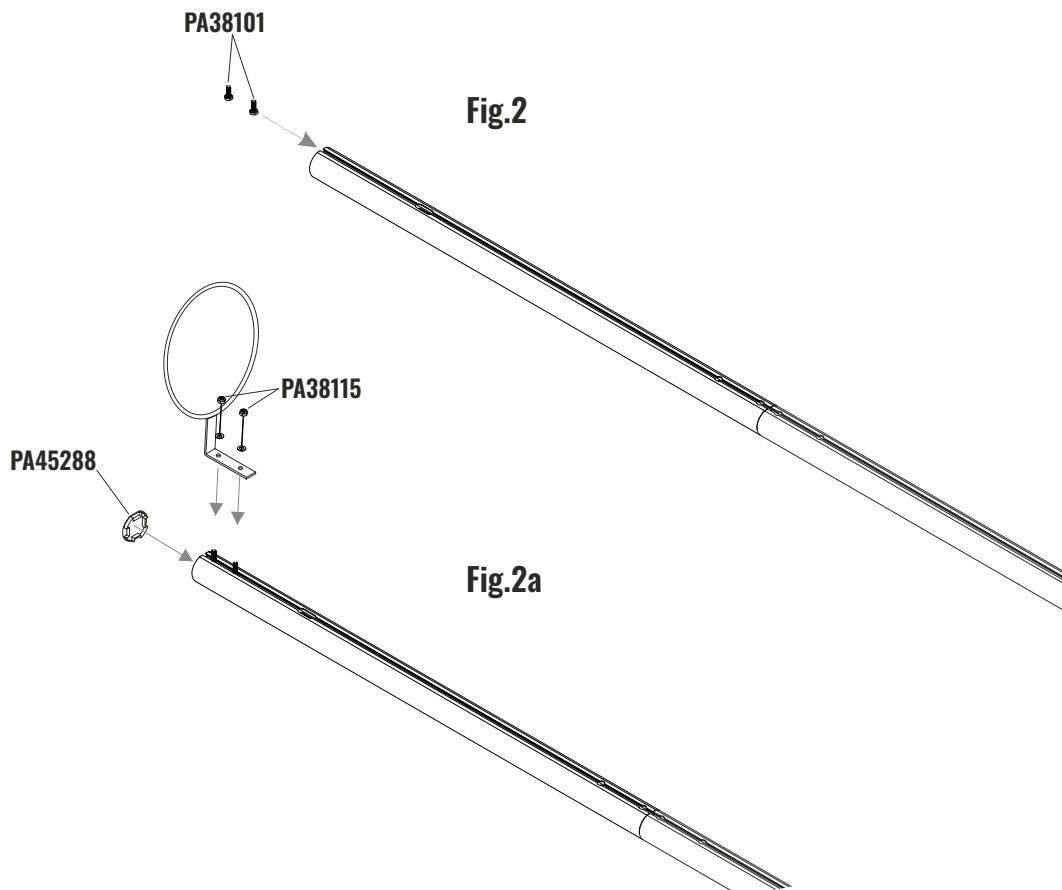

Step 3 - Socket installation.

Over leaf is a guide to ground socket installation outdoors. We recommend seeking advice from an expert sports hall contractor for installation of sockets indoors.

Sockets should be installed by a competent person or persons with knowledge of this kind of work.

Ground Socket Installation

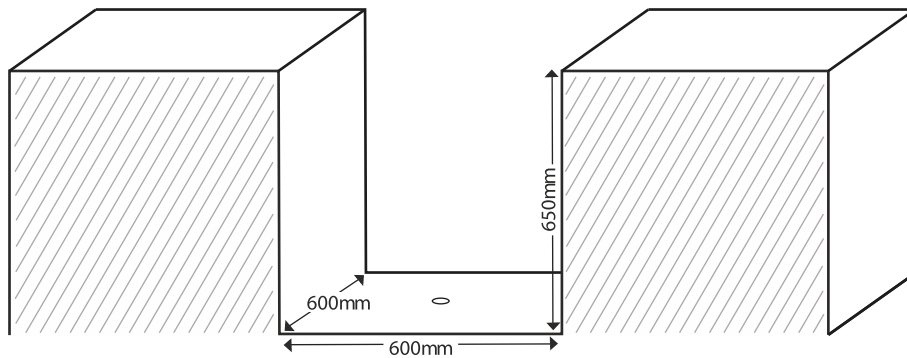

Step 1.

Establish the position of each ground socket. To do this we recommend assembling the posts first and placing this into position where the post will be used.

We recommend marking the 2 socket positions with spray paint where the post meets the ground.

Step 2.

For normal soil conditions dig holes 650mm deep x 600mm square.

If the soil is weak/sandy then the hole size will need to be bigger. Please consult an appropriate grounds contractor for expert advice as we cannot provide this information.

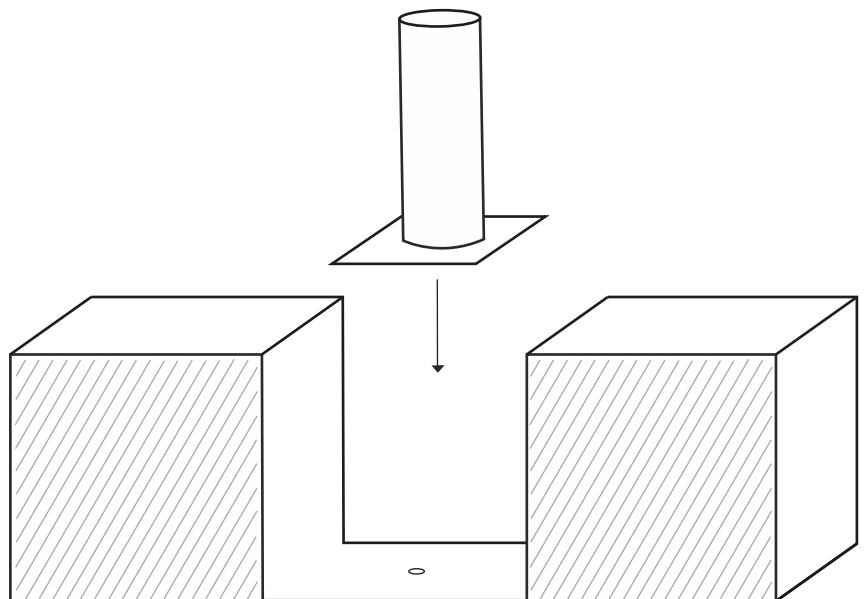

Step 3.

Place the socket correctly into position with the post locator nearest the playing area in the centre of the hole ensuring there is a drainage hole at the base of the socket. If the soil is weak/sandy then you may need to place rubble/stone at the base of the hole to prevent the socket sinking over time.

Pour concrete into the hole and allow to set. Please ensure that you leave a gap of 50 mm at the top of the concrete block to cover with top soil after the concrete is set.

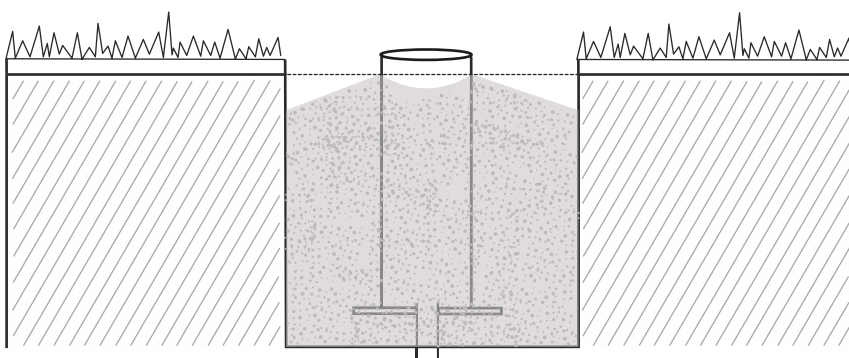

Step 4. Fit post.

Once ground socket is installed slide the post into the socket.

