

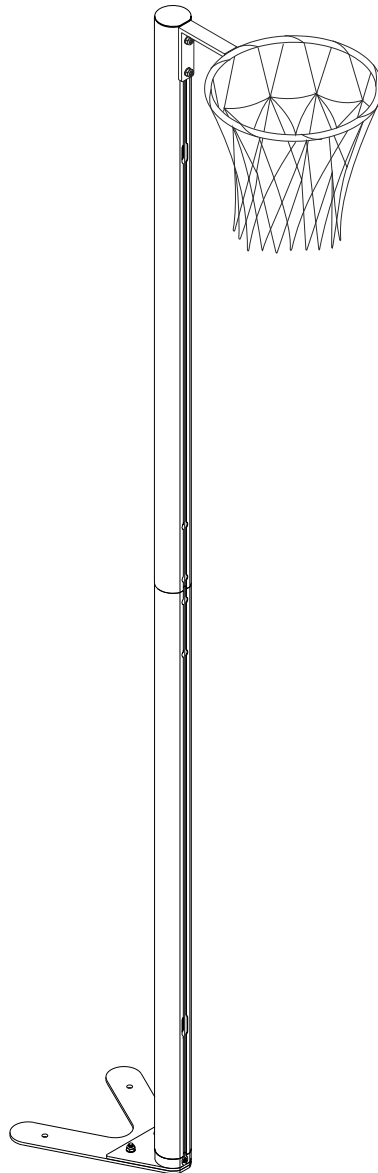



FORZA

FLOOR FIXED NETBALL POST



NET WORLD SPORTS»

    @NetWorldSports

www.networldsports.co.uk // +44 (0) 1691 683 807 // cs@networldsports.co.uk

www.networldsports.com // 1-866-861-9095 // cs@networldsports.com

PARTS LIST

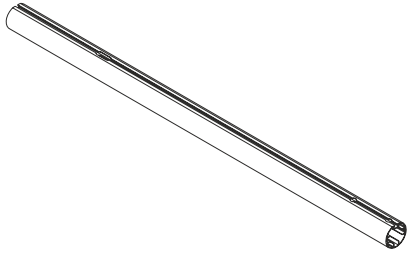

PA45293.
Post (x2)

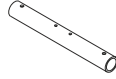

PA45230
Rail connector (x1)

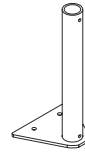

PA45289
Post connector (x1)

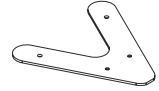

PA45294
Floor fix Base (x1)

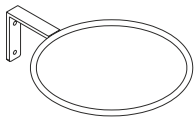

PA45292
Hoop (x1)



PA45288
Rubber end cap (x1)



PA45295
Spacer (x1)



PA45273
M8x16 hex head bolt (x4)



PA38101
M10x20 bolt (x2)

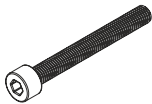

PA45172
M10x80 hex head bolt (x2)



PA45296
M10x30 Countersunk bolt (x2)



PA38115
M10 lock nut (x6)



PA38122
M10 Washer (X10)



PA38133
M8 Spring washer (x4)

HANDY EXTRAS

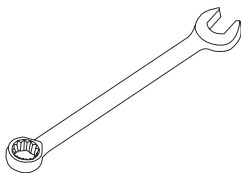

Wrench

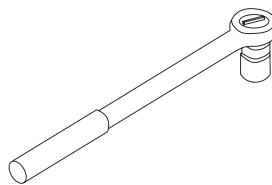

Ratchet

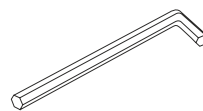

Allen Key

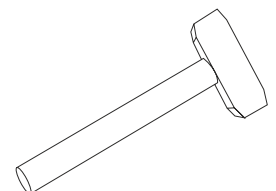

Rubber mallet

IMPORTANT

1. Read through the instructions thoroughly before assembling.
2. Installation, movement and use of equipment should be carried out under the supervision of a competent person using due diligence and risk assessment.
3. Take extreme care when installing, moving and lifting components.
4. Check all parts are present with no defects prior to the assembly.
5. Safety/warning stickers on the product must be visible at all times.
6. Never climb or swing on the product
7. We recommend lubricating/greasing the appropriate components (winders, sockets, inserts, nuts and bolts) to prolong lifespan.
8. Regularly inspect and maintain the equipment to ensure it is safe to use working correctly and to increase lifespan.

2 people will be required to fit post to base

Step 1. Assemble post.

layout out the 2 post sections (PA45293) and the rail connector (PA45230). Slide the rail connector into one end of a post with 2 pre-drilled holes. Align both sets of pre-drilled holes and secure in place with 1 M10x80(PA45172) hex bolt and M10 lock nut (PA38115) using M10 washers (PA38122) in between and 1 M8x16 hex bolt (PA45273) and spring washer (PA38133). See Fig.1.

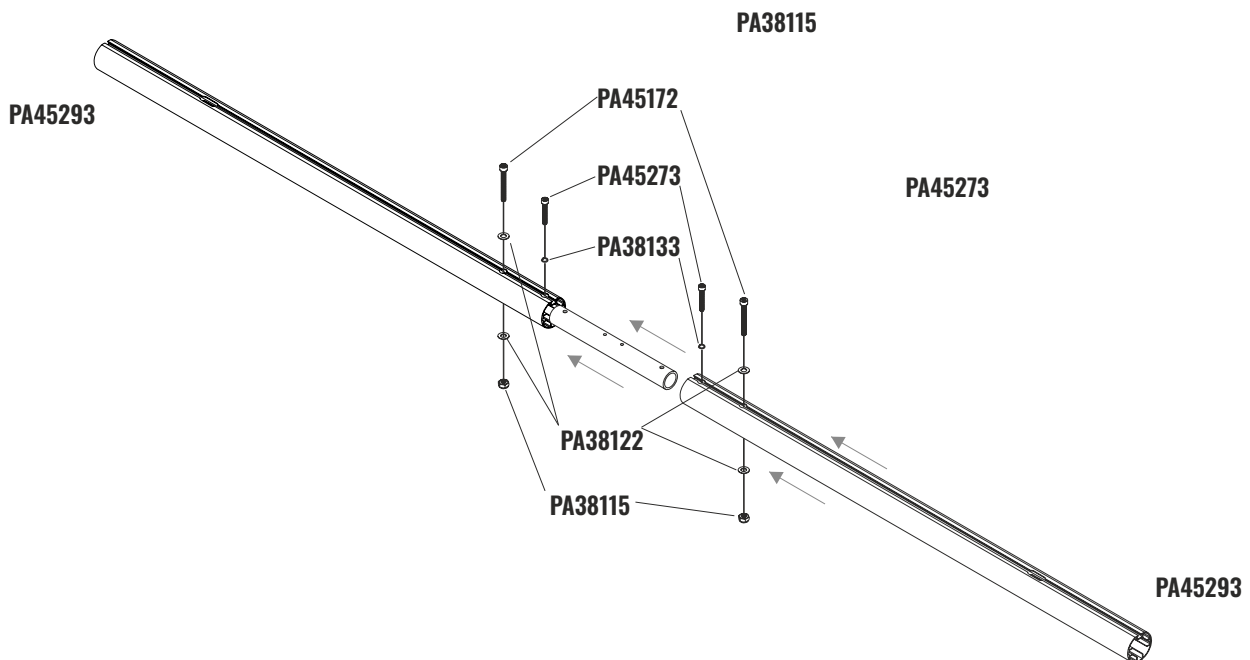

Slide the 2nd post on to the rail connector and secure using same method as above.

Step 2. Fit hoop and End cap.

Slide 2 M10x20 (PA38101) bolts into the channel at 1 end of the assembled post, locate the hoop (PA45292) over the bolts and choose the required position. Once the Hoop is in position secure in place with M10 washers and M10 lock nut. Once hoop is attached tap rubber (PA45288) end cap into place with a rubber mallet. See Fig.2. and Fig.2a

Please note that the net should be attached the hoop at this point.

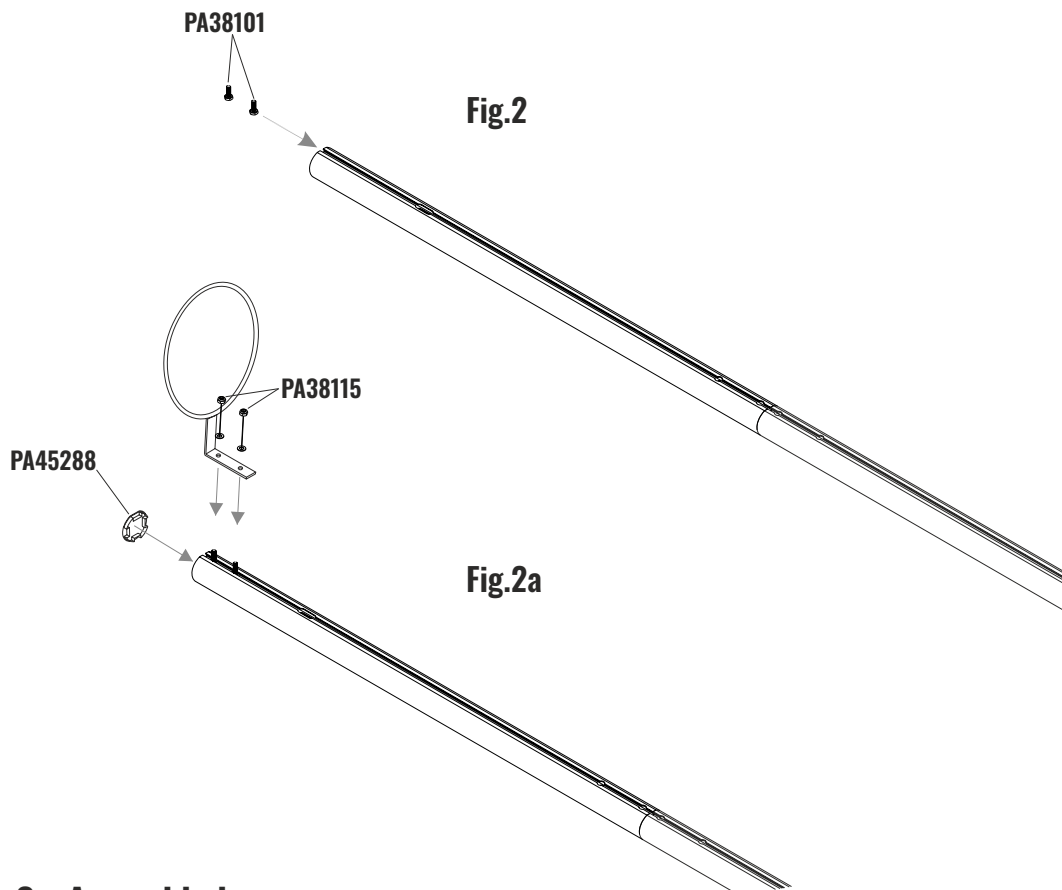

Step 3 - Assemble base

Locate the post connector (PA45289) Over the Ground fixing base, aligning the fixing holes. Secure in place with M10x30 Countersunk bolt (PA45296), M10 washers and M10 nuts. See fig.3.

Fig.3

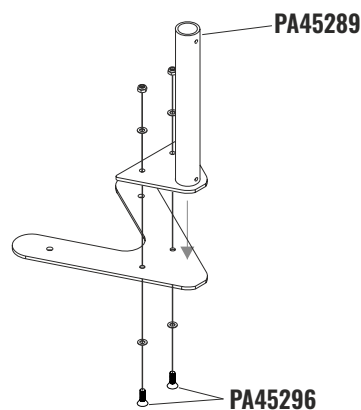

Step 4. Fit post.

Fix the ground fixing base to floor using Ground fixing bolts (not provided).

Locate the Spacer (PA45295) over the post connector with channel facing outwards.

Once the Spacer is in place locate the post over the post connector. Secure in place with the post and spacer in place using M8x16 hex head bolts M8x16 hex head bolts (PA45273) and spring washers. See fig.4. And Fig.4a

